



Long Mynd Road, Bournville Village Trust, Birmingham, B31 1HJ

Offers Over £285,000

3 1 1



Long Mynd Road, Birmingham

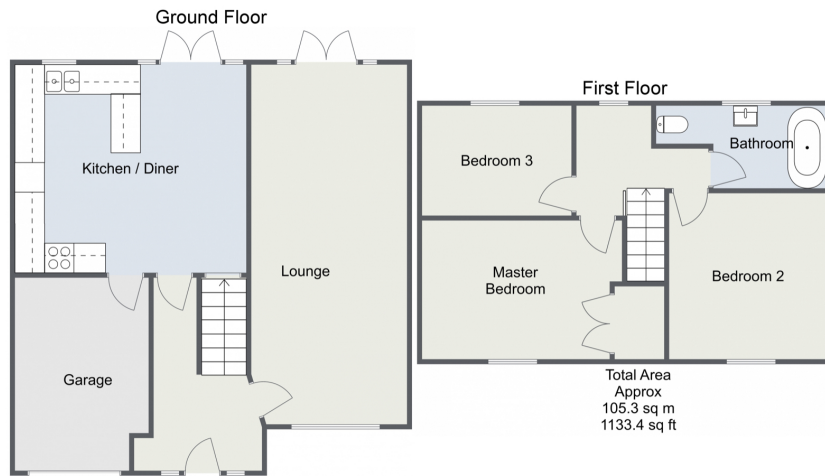

For illustrative purposes only. Decorative finishes, fixtures & fittings do not represent the current state of the property. Measurements are approximate & not to scale. Floor Plans made using RoomSketcher.



A well presented three bedroom terraced house, offered with a modern kitchen, good-sized lounge, landscaped south-east facing rear garden, off road parking and a garage, situated in the sought after Bournville Village Trust, Birmingham.

Energy performance certificate (EPC)

31 Long Mynd Road B31 1HJ	Energy rating C	Valid until: 25 March 2032 Certificate number: 0316-2535-4170-2822-8431
Property type	Mid-terrace house	
Total floor area	113 square metres	

Rules on letting this property

Properties can be let if they have an energy rating from A to E.

You can read [guidance for landlords on the regulations and exemptions](https://www.gov.uk/guidance/domestic-private-rented-property-minimum-energy-efficiency-standards-landlord-guidance) (<https://www.gov.uk/guidance/domestic-private-rented-property-minimum-energy-efficiency-standards-landlord-guidance>).

Energy efficiency rating for this property

This property's current energy rating is C. It has the potential to be B.

[See how to improve this property's energy performance.](#)

Score	Energy rating	Current	Potential
92+	A		
81-91	B		
69-80	C	71	84
55-68	D		
39-54	E		
21-38	F		
1-20	G		

The graph shows this property's current and potential energy efficiency.

Properties are given a rating from A (most efficient) to G (least efficient).

Properties are also given a score. The higher the number the lower your fuel bills are likely to be.

For properties in England and Wales: the average energy rating is D the average energy score is 60

For more information on this house or to arrange a viewing please call the office on:

0121 453 4349

Alternatively, you can scan the QR to view all of the details of this property online.

