



Steepwood Croft, Kings Norton, Birmingham, B30 1AR

Offers Over £190,000

3 1 1



- Three Bedrooms

- Kitchen

- Shower Room

- Lounge/Diner

- Conservatory

- Rear Garden





Steepwood Croft, Birmingham
Ground Floor

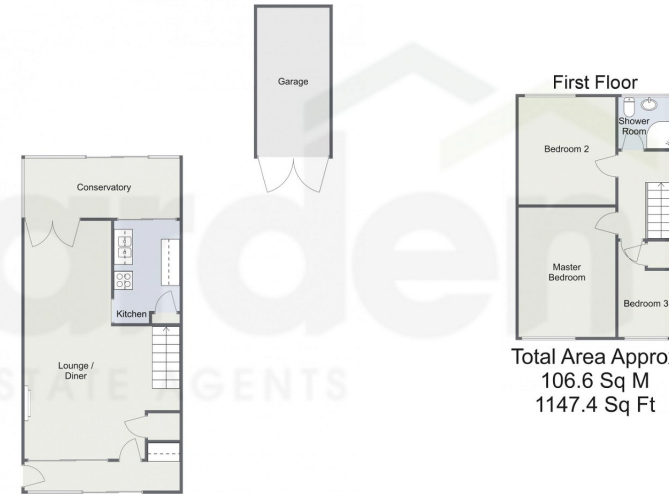

Total Area Approx
106.6 Sq M
1147.4 Sq Ft

For illustrative purposes only. Decorative finishes, fixtures & fittings do not represent the current state of the property. Measurements are approximate & not to scale. Floor Plans made using RoomSketcher.

Nestled in a quiet cul-de-sac, this end of terraced house presents a unique opportunity for those with a vision for transformation. Boasting three generously sized bedrooms, this property is a canvas awaiting modernization to create a stylish and contemporary family home.

Energy performance certificate (EPC)

37 Steepwood Croft BIRMINGHAM B29 1AB	Energy rating C	Valid until: 30 November 2033 Certificate number: 7290-4899-9022-6300-3273
---	---------------------------	---

Property type: End-terrace house
Total floor area: 90 square metres

Rules on letting this property

Properties can be let if they have an energy rating from A to E.

You can read [guidance for landlords on the regulations and exemptions](https://www.gov.uk/guidance/domestic-private-rented-property-minimum-energy-efficiency-standards-landlords-guidance) (<https://www.gov.uk/guidance/domestic-private-rented-property-minimum-energy-efficiency-standards-landlords-guidance>).

Energy rating and score

This property's energy rating is C. It has the potential to be B.

[See how to improve this property's energy efficiency.](#)

The graph shows this property's current and potential energy rating.

Properties get a rating from A (best) to G (worst) and a score. The better the rating and score, the lower your energy bills are likely to be.

For properties in England and Wales:
the average energy rating is D
the average energy score is 60

For more information on this house or to arrange a viewing please call the office on:

0121 453 4349

Alternatively, you can scan the QR to view all of the details of this property online.

