



Lyttleton Street, Worcester WR1 3JN

£275,000

3 1 1



Summary:

Nestled amidst the pretty Victorian lined street of Lyttleton Street boasts a timeless elegant mid terrace house. This home has been modernised whilst still retaining character features. Located in the heart of Barbourne, close to Pitchcroft racecourse and river walks, this home is a must see. The property in brief comprises; lounge, kitchen/diner, w/c, three bedrooms and bathroom. The property benefits from gas central heating, double glazing, cellar and low maintenance front and rear gardens.

Description:

Access is gained via front door leading into lounge. Feature bay window allowing lots of natural light and exposed brick feature fireplace and fire. Stairs to cellar and first floor. The kitchen/diner has feature fireplace and patio doors leading onto the rear garden. The kitchen offers base and eye level units with roll top work surfaces. Built in appliances to include; extractor fan, gas hob and oven. Space for fridge/freezer and plumbing for washing machine. To the first floor are two bedrooms with the master having built in wardrobe. The bathroom offers a four piece white suite with feature freestanding bath and half tiled walls. To the second floor is bedroom three. The property benefits from gas central heating, double glazing, cellar and low maintenance front and rear gardens.

Outside:

Access is gained via kitchen/diner. The rear garden is low maintenance and is laid to slabbed, perfect for garden furniture, pots and alfresco dining. Gate for access. Door to w/c. To the front is an enclosed garden laid to gravel.

Location:

Lyttleton Street is located in a prime position a short distance from Worcester City Centre. Conveniently located close to the Racecourse and river walks. You have access into the City which have bus and rail links, restaurants and shopping facilities. Direct rail links to Birmingham and London. There is excellent schooling with the RGS



Lyttleton Street, Worcester

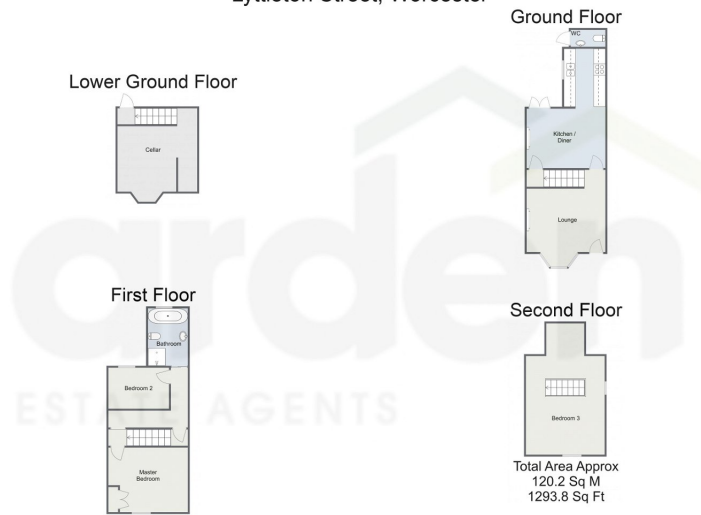

For illustrative purposes only. Decorative finishes, fixtures & fittings do not represent the current state of the property. Measurements are approximate & not to scale. Floor Plans made using RoomSketcher.

- End of Terrace Victorian Home
- Three Bedrooms and Bathroom
- Low Maintenance Rear Garden
- Lounge and Kitchen/Diner
- Cellar and W/C
- Popular Barbourne Location

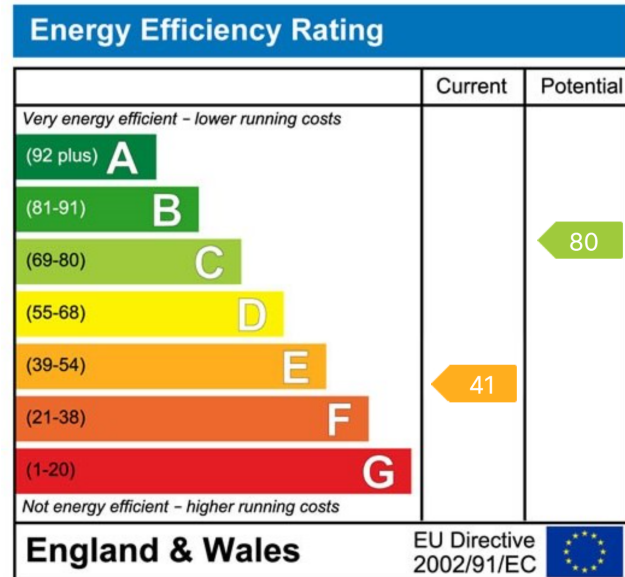

For more information on this house or to arrange a viewing please call the office on:

01905 958 290

Alternatively, you can scan the QR to view all of the details of this property online.

