



Ryde Park Road, Rednal, Birmingham, B45 8RQ

Offers Over £190,000

🛏️ 2 🚿 1 🚗 1



- Two Bedrooms
- Kitchen
- Lean to and Store
- Rear Garden
- Lounge with Feature Fireplace
- Dining Room
- Family Bathroom
- Close to Amenities



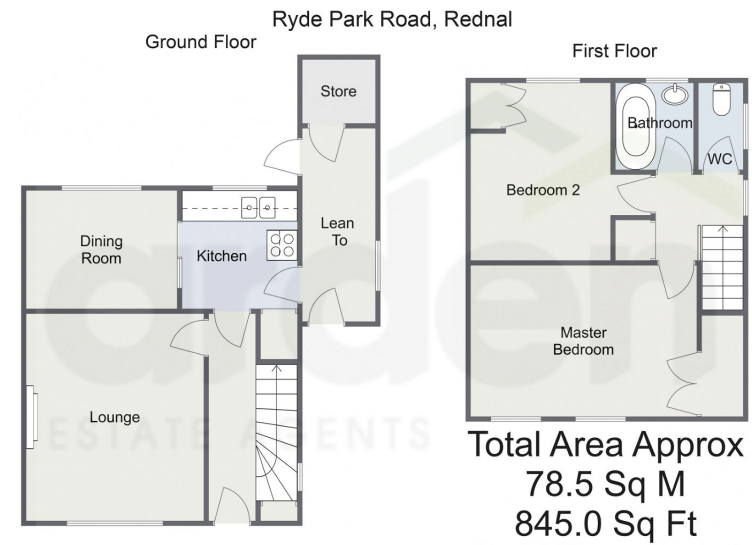

For illustrative purposes only. Decorative finishes, fixtures & fittings do not represent the current state of the property. Measurements are approximate & not to scale. Floor Plans made using RoomSketcher.

A semi-detached, two-bedroom residence awaits transformation through modernisation, boasting pre-approved planning permission for the construction of a two-storey and single-storey side extension. The property offers a large driveway for off road parking, an expansive lounge adorned with a distinctive fireplace, a well-appointed kitchen, an additional reception room, a family bathroom, and a rear garden.

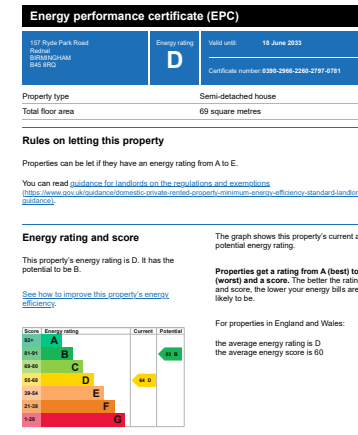

For more information on this house or to arrange a viewing please call the office on:

0121 453 4349

Alternatively, you can scan the QR to view all of the details of this property online.

