



The logo for Arden Estate Agents, featuring a green house icon above the word "arden" in a bold, white, sans-serif font, with "ESTATE AGENTS" in a smaller, white, sans-serif font below it.

arden
ESTATE AGENTS

It's who
you move
with.

4 Greenfield Cottages, Scarfield Hill, Alvechurch, B48 7SF

Guide Price £275,000

3 1 1



Summary

A charming two/three bedroom Victorian cottage with rear parking situated in an idyllic semi-rural location yet within close proximity to local amenities within Alvechurch and just a stone's throw from the train station, popular public house and the Worcester and Birmingham canal.

Description

The accommodation comprises: Open entrance hall, charming lounge with open fire and built in alcove shelving/cupboards leading to an open plan farmhouse style kitchen/dining room with garden access and ground floor shower room. Both the lounge and kitchen/diner feature stunning black cast iron radiators.

A set of stairs from the kitchen leads to two first floor bedrooms and a third bedroom/loft room is accessed via bedroom 2, featuring eaves storage.

Outside

The rear garden is predominantly laid to lawn with fenced boundaries and pathway leading to an area of hard standing. Beyond the garden lies an area suitable for rear parking, with vehicular access via a shared private road off Scarfield Hill.

Location

Set in a semi rural position within Alvechurch, the property is conveniently located close to the Worcester and Birmingham Canal, Alvechurch Marina, train station and local public house, 'The Weighbridge'. Approximately 0.5 miles from the property lies the centre of Alvechurch village which offers two Nurseries, First School (Crown Meadow), Middle School (Alvechurch Church of England School) and several shopping and eating facilities. Also, further afield are the facilities offered by both Redditch and Barnt Green Village.





- Lounge - 3.82m x 3.35m (12'6" x 10'11") max
- Shower Room - 2.15m x 1.36m (7'0" x 4'5")
- Bedroom 2 - 3.43m x 3.37m (11'3" x 11'0") max
- Kitchen/Diner - 6.85m x 3.37m (22'5" x 11'0") max
- Master Bedroom - 3.42m x 3.42m (11'2" x 11'2")
- Bedroom 3 / Loft Room - 3.36m x 3.35m (11'0" x 10'11") max



Greenfield Cottages, Scarfield Hill, Alvechurch
Ground Floor

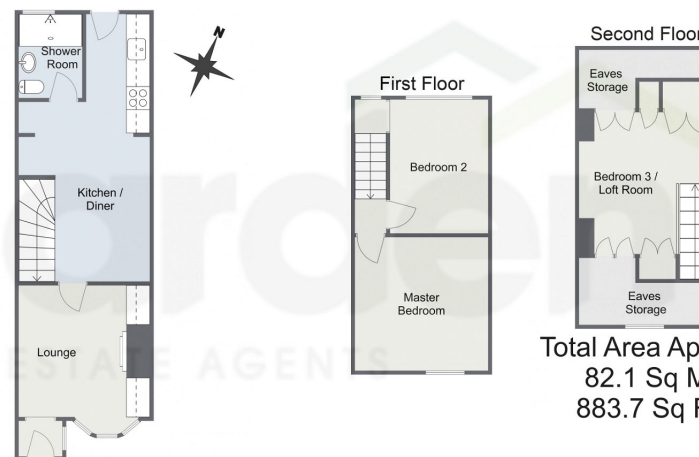

Total Area Approx
82.1 Sq M
883.7 Sq Ft

For illustrative purposes only. Decorative finishes, fixtures & fittings do not represent the current state of the property. Measurements are approximate & not to scale. Floor Plans made using RoomSketcher.

For more information on this house or to arrange a viewing please call the office on:

0121 447 8300

Alternatively, you can scan the QR to view all of the details of this property online.

