



It's who  
you move  
with.

# Bridgeview House, Woodhouse Close, Worcester, WR5 3FQ

Offers Over £155,000

1 1 1



## Summary:

A stunning, light and airy mid floor apartment, situated in the popular Diglis area. Close to river walks and Diglis Marina as well as being a stone throw away from the city centre with shops, bars and restaurants. This would make a perfect first buy or investment. The property in brief comprises; open plan living/kitchen/diner, one bedroom and bathroom. The property benefits from gas central heating, double glazing, balcony and allocated parking. Viewing is recommended to appreciate this lovely apartment.

## Description:

Access is via communal door with either lift or stairs to your floor. Door into hallway. Modern and contemporary open plan living/kitchen/dining area with storage cupboard. The kitchen area offers base and eye level units with roll top work surfaces and tiled splashback. Built in appliances to include; extractor fan, hob, oven, fridge/freezer, dishwasher and washing machine. French doors onto the balcony. Generous double bedroom. Family bathroom offers a three piece white suite with half tiled walls and built in recess shelf. The property benefits from gas central heating, double glazing, balcony and allocated parking.

## Outside:

French doors open onto the balcony. The perfect spot to sit, relax and enjoy alfresco dining. Secure, gated allocated parking space.

## Location:

Situated in the popular Diglis area of Worcester, with playing fields, gym, a hotel and pubs all within a short reach. This is an attractive location due to its close proximity to the city centre which offers wine bars, restaurants and lots more. Foregate Street Station is in the city if you need to commute and you are also perfectly positioned for canal and river walks.

## Agent Note:



Bridgeview House, Woodhouse Close, Worcester

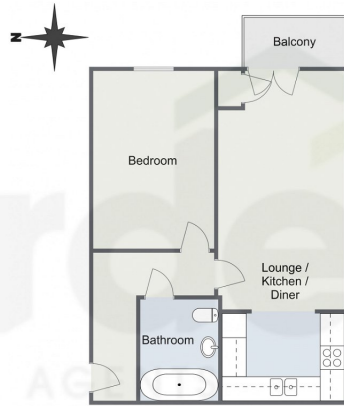

Total Area Approx  
54.6 Sq M  
587.7 Sq Ft

For illustrative purposes only. Decorative finishes, fixtures & fittings do not represent the current state of the property. Measurements are approximate & not to scale. Floor Plans made using RoomSketcher.

- Mid Floor Apartment
- Open Plan Living/Kitchen/Diner
- Balcony and Secure Gated Parking
- Perfect First Buy or Investment
- Double Bedroom and Bathroom
- Popular Diglis Location

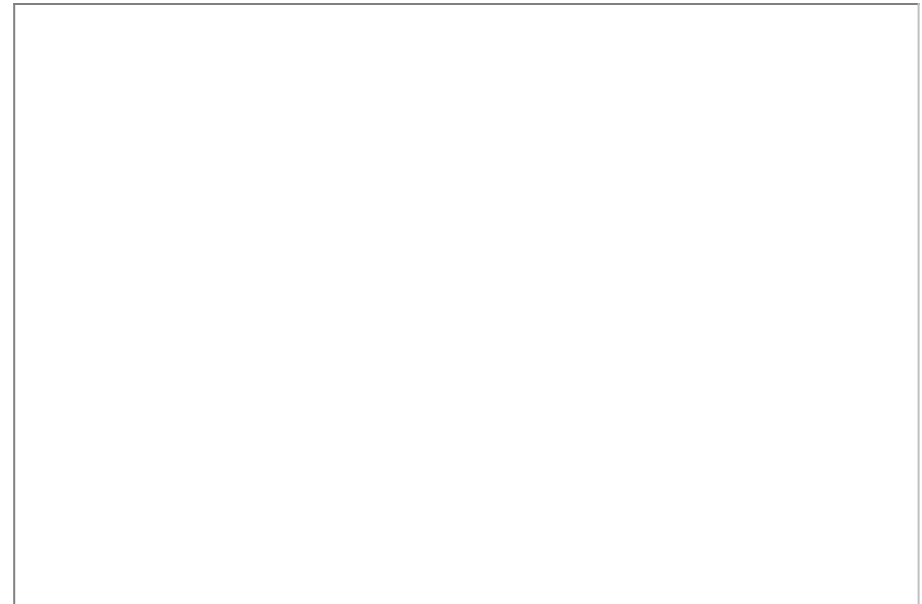

For more information on this house or to arrange a viewing please call the office on:

**01905 958 290**

Alternatively, you can scan the QR to view all of the details of this property online.



**arden**  
ESTATE AGENTS