



Well Meadow, Rednal, Birmingham, B45 9NE

£190,000

🛏️ 2 🚿 1 🚻 1



- Two Bedrooms
- Kitchen/Diner
- Front and Rear Garden
- Spacious Lounge
- Family Bathroom
- Allocated Parking Space





Discover the charm of this well presented two-bedroom terraced property in Rednal, Birmingham, featuring allocated parking, front and rear gardens, a spacious lounge, kitchen/ diner, and a family bathroom, offering a perfect blend of comfort and convenience.

Well Meadow, Rednal
Ground Floor

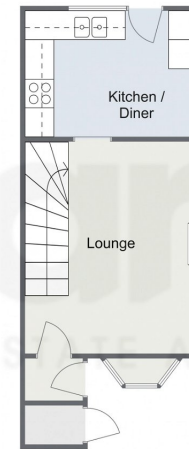

First Floor

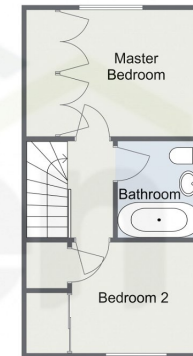

Total Area Approx
54.1 Sq M
582.3 Sq Ft

For illustrative purposes only. Decorative finishes, fixtures & fittings do not represent the current state of the property. Measurements are approximate & not to scale. Floor Plans made using RoomSketcher.

4/23/24, 2:57 PM Energy performance certificate (EPC) - Find an energy certificate - GOV.UK

Energy performance certificate (EPC)	
Energy rating C	Valid until 18 April 2034 Certificate number 3434-6124-1300-0641-729
Property type Mid-terrace house Total floor area 54 square metres	
Rules on letting this property Properties can be let if they have an energy rating from A to E. You can read guidance for landlords on the regulations and exemptions (https://www.gov.uk/guidance/domestic-rivale-tenanted-property-minimum-energy-efficiency-standard-landlord-guidance).	
Energy rating and score This property's energy rating is C. It has the potential to be A. See how to improve this property's energy efficiency.	The graph shows this property's current and potential energy rating. Properties get a rating from A (best) to G (worst) and a score. The better the rating and score, the lower your energy bills are likely to be. For properties in England and Wales: the average energy rating is D the average energy score is 60

<https://find-energy-certificates.service.gov.uk/energy-certificates/3434-6124-1300-0641-729?print=true>

1/4

For more information on this house or to arrange a viewing please call the office on:

0121 453 4349

Alternatively, you can scan the QR to view all of the details of this property online.

