



Callowbrook Lane, Rednal, Birmingham, B45 9TG

£265,000

🛏️ 3 🚿 1 🚗 2



- Three bedrooms
- Open Plan Kitchen/Diner
- Rear Garden
- Open Porch
- Spacious Lounge
- Family Bathroom
- Off Road Parking
- Complete Renovation





Callowbrook Lane, Rednal

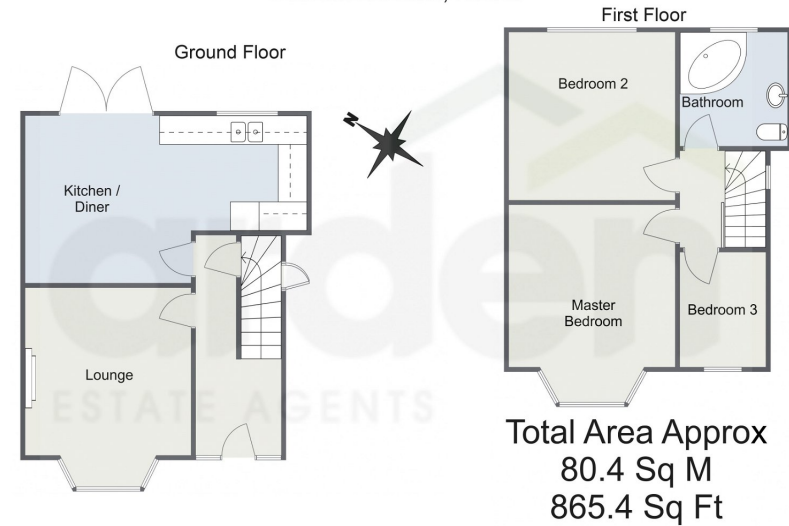

For illustrative purposes only. Decorative finishes, fixtures & fittings do not represent the current state of the property. Measurements are approximate & not to scale. Floor Plans made using RoomSketcher.

Discover modern comfort in this newly renovated three-bedroom semi-detached property in Rednal, Birmingham, featuring a convenient driveway, spacious lounge, open-plan kitchen/diner, family bathroom, and a serene rear garden.

4/19/24, 2:18 PM Energy performance certificate (EPC) - Find an energy certificate - GOV.UK

Energy performance certificate (EPC)

Energy rating	Valid until	17 May 2033
E	Certificate number	6340-2278-1255-2897-6463

191 Callowbrook Lane
Rednal
BIRMINGHAM
B45 9TD

Property type Semi-detached house
Total floor area 79 square metres

Rules on letting this property

Properties can be let if they have an energy rating from A to E.

You can read [guidance for landlords on the regulations and exemptions](https://www.gov.uk/guidance/landlords-privately-letted-property-minimum-energy-efficiency-standard-landlord-guidance).

Energy rating and score

This property's energy rating is E. It has the potential to be C.

The graph shows this property's current and potential energy rating.

Properties get a rating from A (best) to G (worst) and a score. The better the rating and score, the lower your energy bills are likely to be.

For properties in England and Wales:
the average energy rating is D
the average energy score is 50

Score	Energy rating	Current	Potential
91-100	A		
81-90	B		
69-80	C		
55-68	D		
39-54	E	44.5	
21-38	F		
1-20	G		

For more information on this house or to arrange a viewing please call the office on:
0121 453 4349

Alternatively, you can scan the QR to view all of the details of this property online.

