



Woodham Close, Rubery, Birmingham, B45 9YP

£375,000

🛏️ 4 🚿 2 🚗 2



- Four Bedrooms
- Two Reception Rooms
- Kitchen / Diner
- Downstairs WC
- Conservatory
- En-Suite and Family Bathroom
- Off Road Parking
- Garage
- Close To Amenities
- Good Transport Links



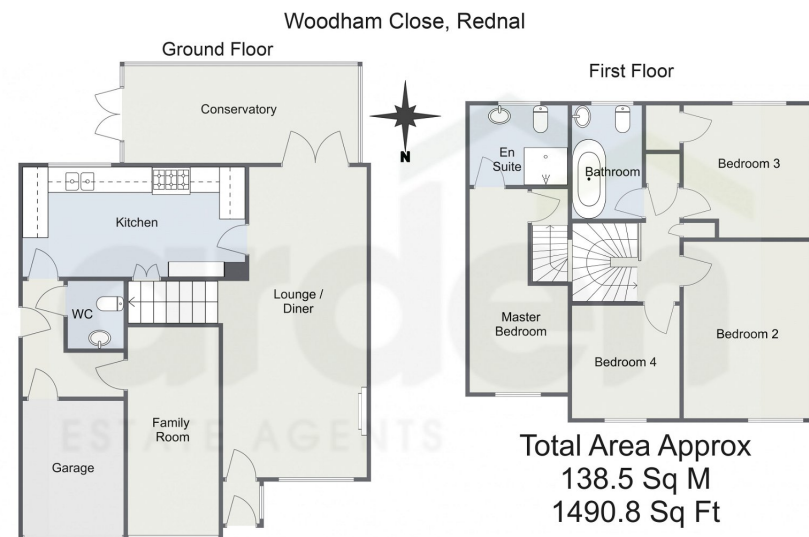

For illustrative purposes only. Decorative finishes, fixtures & fittings do not represent the current state of the property. Measurements are approximate & not to scale. Floor Plans made using RoomSketcher.

A well presented four bedroom semi-detached house, offered with two reception rooms, breakfast kitchen, an en suite to the master bedroom and a conservatory leading out the the south-facing rear garden, situated in Rubery, Birmingham.

For more information on this house or to arrange a viewing please call the office on:

0121 453 4349

Alternatively, you can scan the QR to view all of the details of this property online.

