



Dencer Close, Rubery, Birmingham

Offers Over £240,000

3 1 1



- Three Bedrooms
- Kitchen/Diner
- Rear Garden
- Off Road Parking
- Lounge
- Family Bathroom
- Garage
- Close to Amenities



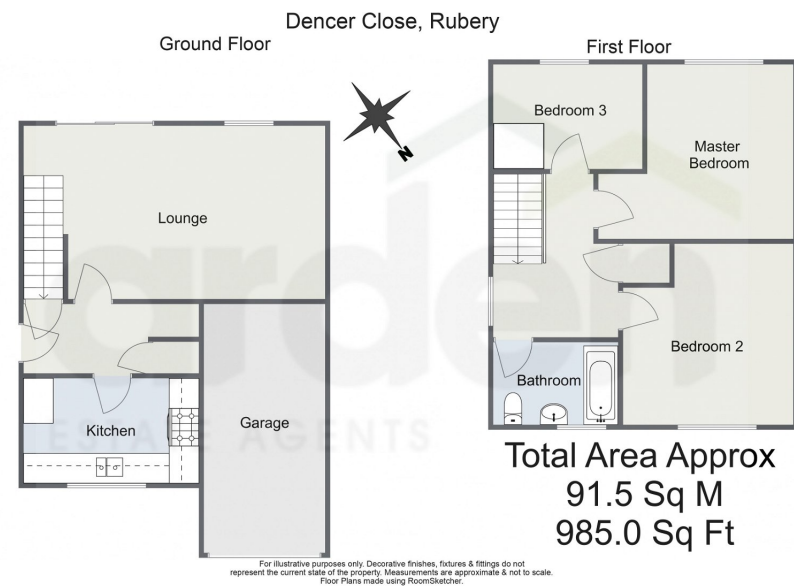

This well-presented three-bedroom semi-detached house, situated on a corner plot in a quiet close in Rubery, Birmingham, offers the potential for side extension (subject to planning permission). The property features a kitchen, a comfortable lounge, a south-west facing rear garden, and off-road parking with a garage.

6/24 2:44 PM Energy performance certificate (EPC) - Find an energy certificate - GOV.UK

Energy performance certificate (EPC)		
2 Dencer Close Rubery Bordesley Green BBS 9YU	C	Valid until: 29 May 2034 Certificate number: 7008-3038-1205-1814-5209
Property type	Semi-detached house	
Total floor area	76 square metres	
Rules on letting this property		
Properties can be let if they have an energy rating from A to E.		
You can read guidance for landlords on the regulations and exemptions https://www.gov.uk/guidance/tenants-should-ensure-rented-property-meets-minimum-energy-efficiency-standards		
Energy rating and score		
This property's energy rating is C. It has the potential to be B. See how to improve this property's energy efficiency.		The graph shows this property's current and potential energy rating. Properties get a rating from A (best) to G (worst) and a score. The better the rating and score, the lower your energy bills are likely to be.
		For properties in England and Wales: the average energy rating is D the average energy score is 60

<https://find-energy-certificates.service.gov.uk/energy-certificates/7008-3038-1205-1814-5209/printview> 1/4

For more information on this house or to arrange a viewing please call the office on:
0121 453 4349

Alternatively, you can scan the QR to view all of the details of this property online.

