



Hagley Park Drive, Rednal, Birmingham, B45 9JZ

Offers Over £305,000

4 1 2



- Four Bedrooms
- Modern Kitchen
- Downstairs WC
- Rear Garden
- Integral Garage
- Spacious Lounge
- Dining Room
- Contemporary Family Bathroom
- Driveway for Off Road Parking
- Close to Amenities



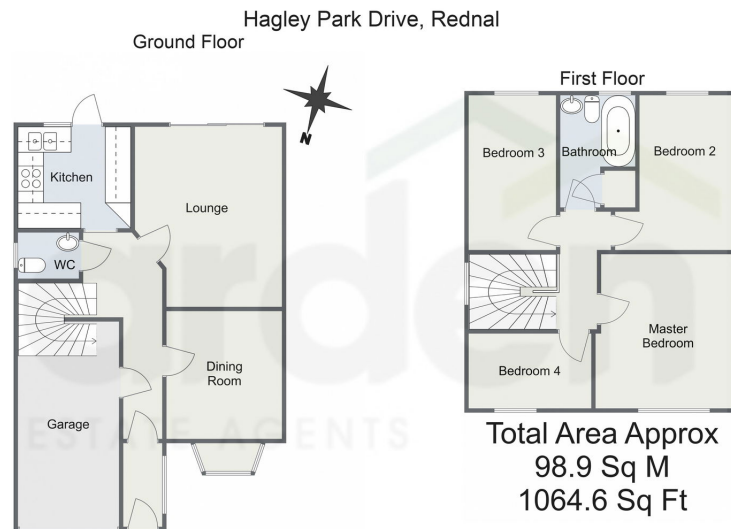

For illustrative purposes only. Decorative finishes, fixtures & fittings do not represent the current state of the property. Measurements are approximate & not to scale. Floor plans made using RoomSketcher.

Presenting a stunning four-bedroom detached home in Rednal, Birmingham, featuring a spacious lounge, newly renovated kitchen, elegant dining room, convenient downstairs WC, modern family bathroom, and a rear garden. The property also offers off-road parking with a driveway leading to an integral garage.

8/1/2024, 3:32 PM

Energy performance certificate (EPC) - Find an energy certificate - GOV.UK

Energy performance certificate (EPC)

| | | |
|---|----------------------------------|---|
| 6 Hagley Park Drive Rednal B37 4JZ BPD SUZ | Energy rating C | Valid until 11 August 2034 Certificate number 5720-8089-0384-2008-1413 |
| Property type Detached house | | Total floor area 87 square metres |

Rules on letting this property

Properties can be let if they have an energy rating from A to E.

You can read [guidance for landlords on the regulations and exemptions](https://www.gov.uk/guidance/landlords-on-the-regulations-and-exemptions).

<https://www.gov.uk/guidance/landlords-on-the-regulations-and-exemptions#energy-efficiency-standards-landlord-guidance>

Energy rating and score

This property's energy rating is C. It has the potential to be B.

[See how to improve this property's energy efficiency.](#)

The graph shows this property's current and potential energy rating.

Properties get a rating from A (best) to G (worst) and a score. The better the rating and score, the lower your energy bills are likely to be.

For properties in England and Wales:
the average energy rating is D
the average energy score is 60

https://find-energy-certificate.service.gov.uk/energy-certificates/5720-8089-0384-2008-1413?print=true

1/4

For more information on this house or to arrange a viewing please call the office on:

0121 453 4349

Alternatively, you can scan the QR to view all of the details of this property online.

